

Quick Start Guide

Unbox, set up and power-on your robot in less than 30 minutes!

0

Please read the safety information before unboxing your robot. ⚠

Directives, warnings and safety considerations for the KINOVA® Gen3 Ultra lightweight robot.

⚠ General

Do not connect the USB ports on the base to one another.
It is recommended that surge protection be used to protect the robot against external surges on the main AC line which might be caused by lightning or other abnormal conditions.
The base must be mounted as specified in the installation section, with particular attention to the bolt pattern, strength requirements and any table or tripod-specific mounting.
The end effector must be mounted as specified in the installation section (including bolt pattern, power requirements, etc).

⚠ Maintenance

Immediately following exposure to saline air conditions, contact Kinova support to schedule maintenance by authorized Kinova technician.
The controller mating interface needs to be kept free of dust and moisture to protect the electrical contacts. Wipe down with a soft dry cloth to keep the surface of the interface clean.

⚠ Safety

There is no mechanical brake on the robot. If the power supply is cut or an unrecoverable error occurs, be aware that the robot will fall. However, mechanisms are in place within the actuators slow the descent without external power.	
For your personal safety, and that of others, it is strongly recommended that the following be carried out:	<ul style="list-style-type: none">• risk assessment, before integration of the robot into a given application.• hazard analysis, before integration into an environment which includes atomized flammable dust / particles or explosives / flammable gases, etc.
For your personal safety, and that of others, never:	<ul style="list-style-type: none">• use the robot near a flame or source of heat.• exceed the maximum specified payload.• attempt to stop the robot or prevent its movement by holding it (except in admittance mode).
For your personal safety, and that of others, always ensure that:	<ul style="list-style-type: none">• the robot does not encounter any obstacles (person or objects). Although inherently safe in its default configuration, disabling the robot safeties requires that the user be responsible for ensuring a secure working space.• the end effector never collides with a hard surface.• the grasping of objects by gripper fingers is stable, to prevent the risk of dropped or thrown objects (if using a gripper).• the wrist is supported before turning the power off (otherwise it may fall and cause damage).• eye protection is worn when manipulating fragile objects with the robot.• the working area is safe when containers of hot (or extremely cold) liquids are to be manipulated with the robot.• the robot has its base securely fixed to the work surface when in operation.
The robot should not be used without the provided emergency stop connected.	
Do not operate the robot when the relative humidity exceeds the maximum specified. In such a case, put down any object in the gripper, bring the robot to a resting position and wait until the humidity decreases to an allowable value.	
The robot is not certified for use in applications in sterile environments (e.g. food production, pharmaceuticals, medical, or surgical).	

1

What's inside

2

Mounting and setup

3

Power-on

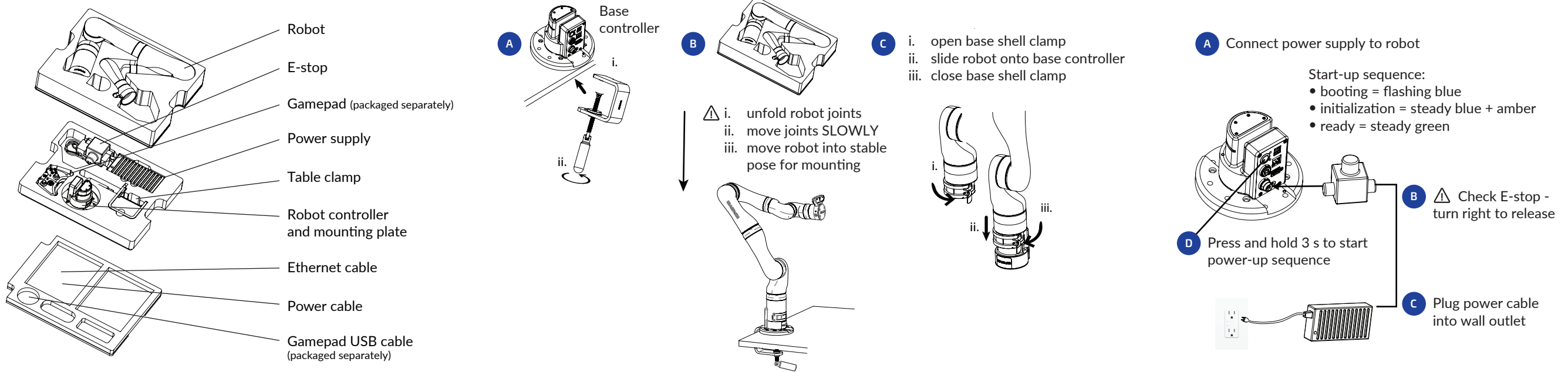

4

Controlling robot with gamepad

5

Exploring admittance control

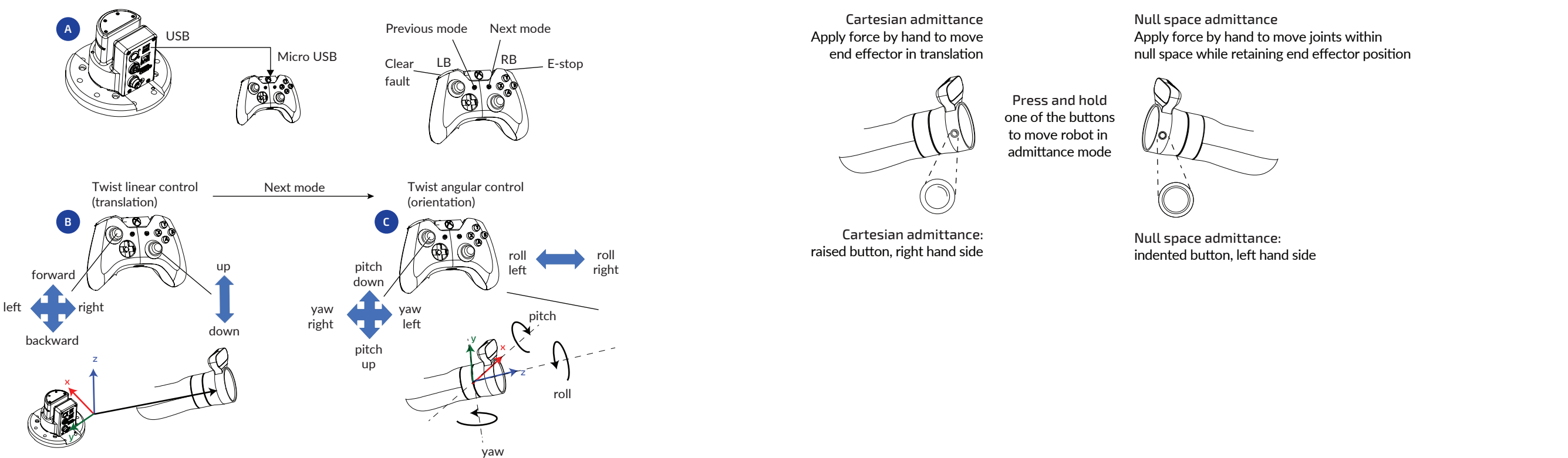

6

Connecting computer and configuring wired LAN settings

7

Accessing the robot via KINOVA® KORTEX™ Web App

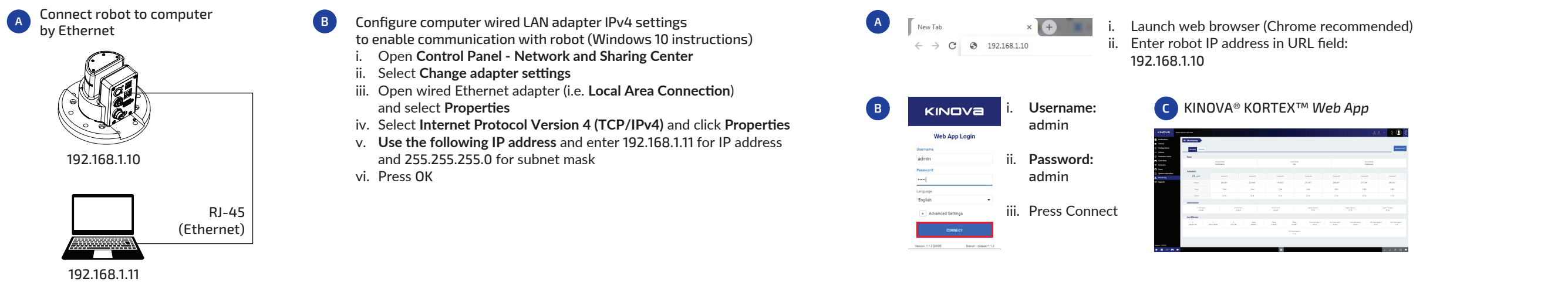

8

Playing a preset trajectory (sequence)

9

Going farther: API, documentation and other resources

